

FLOW CONTROL MANHOLE DETAIL
SCALE 1:25

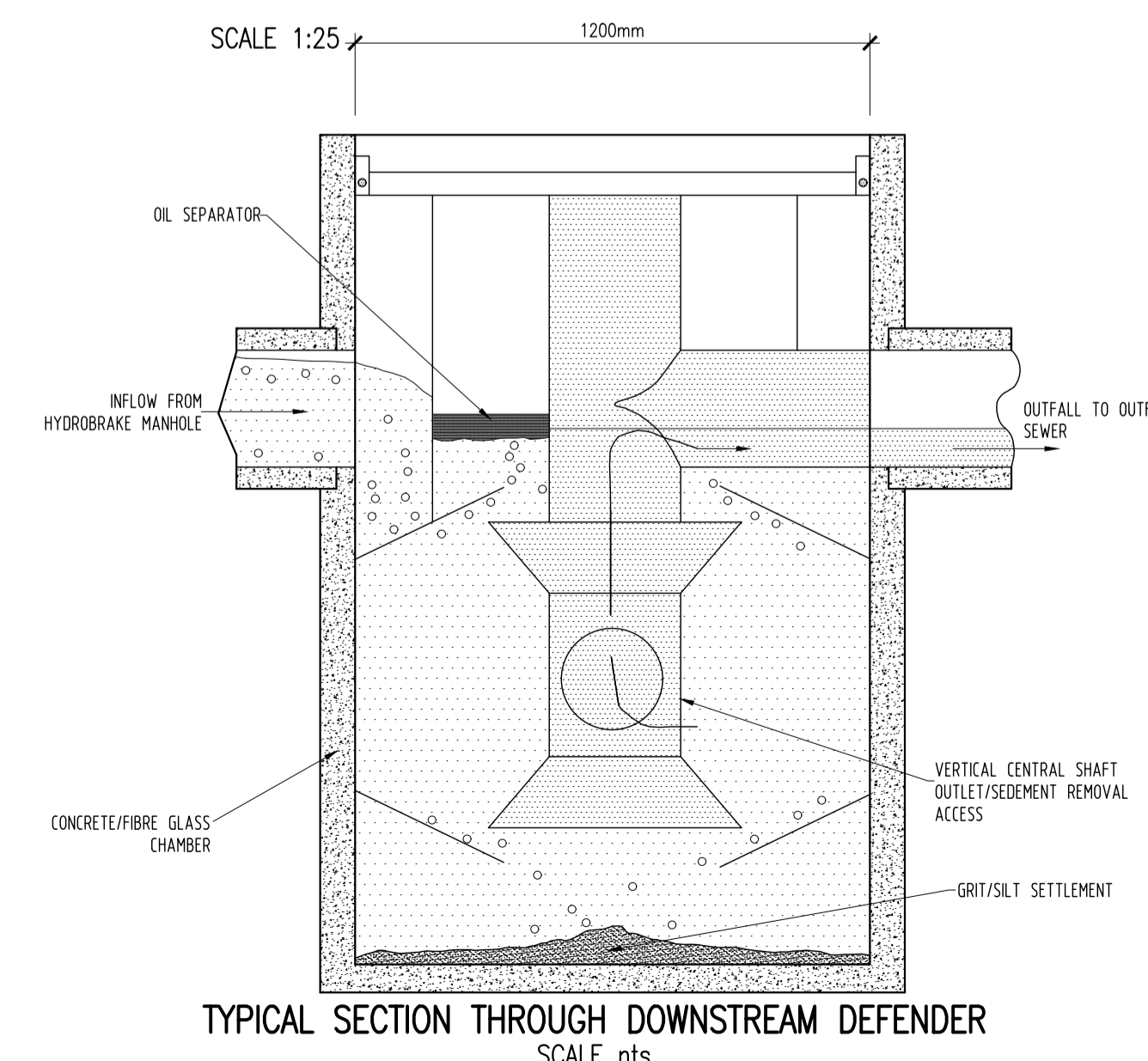

TYPICAL SECTION THROUGH DOWNSTREAM DEFENDER
SCALE 1:25

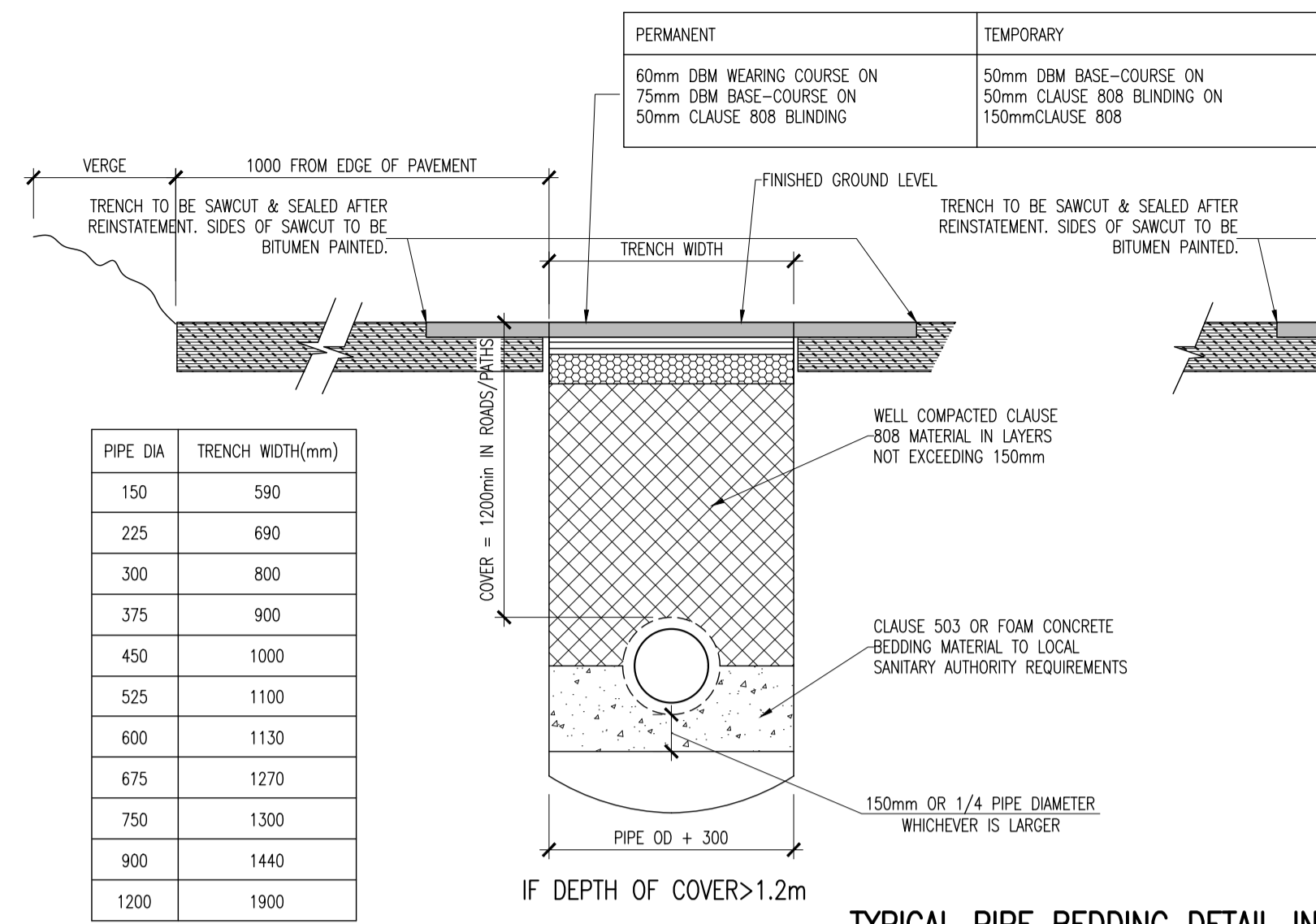

PIPE DIA	TRENCH WIDTH(mm)
150	590
225	690
300	800
375	900
450	1000
525	1100
600	1130
675	1270
750	1300
900	1440
1200	1900

TYPICAL PIPE BEDDING DETAIL IN ROADWAYS/FOOTPATHS
SCALE 1:25

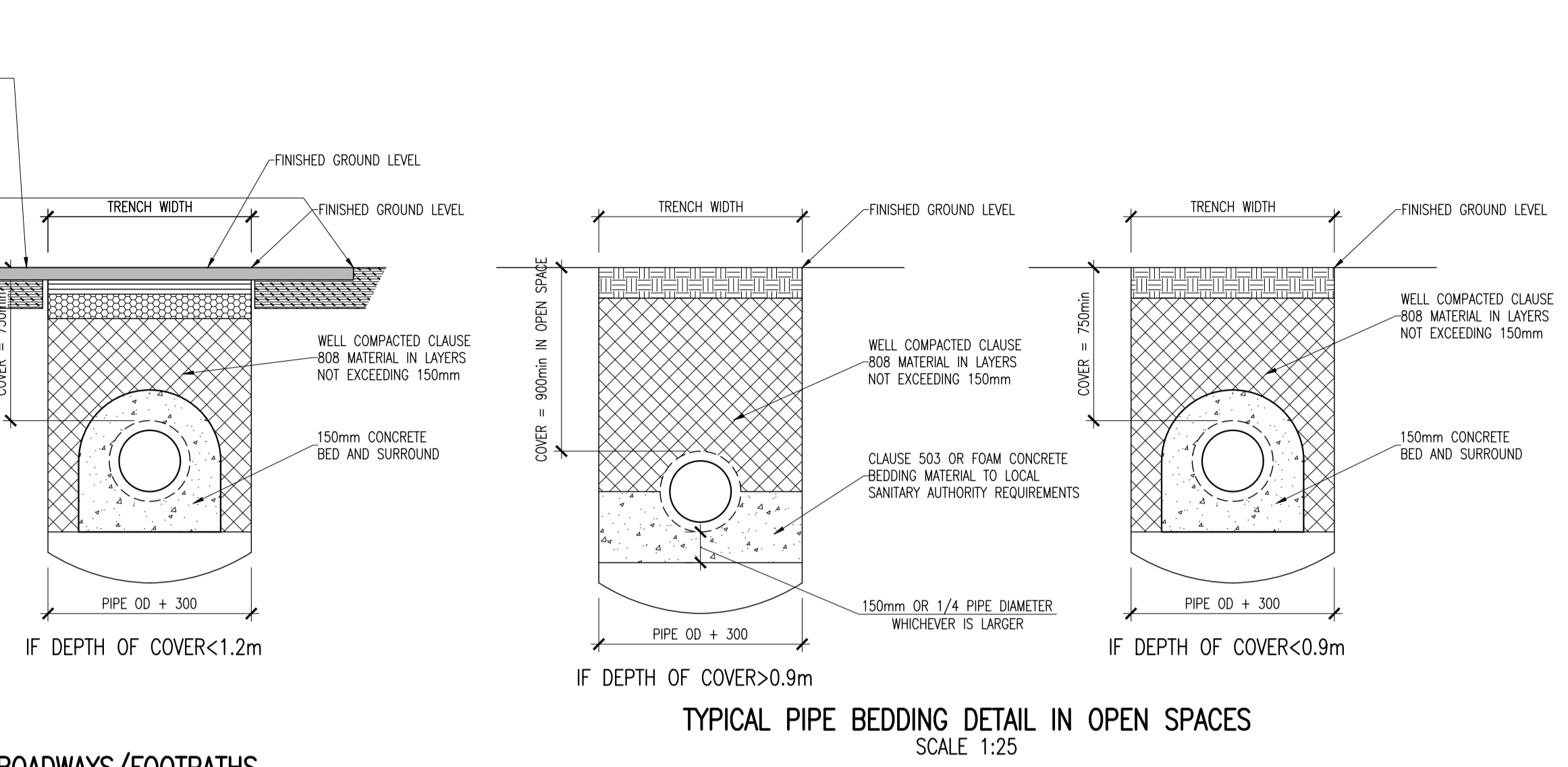

TYPICAL PIPE BEDDING DETAIL IN OPEN SPACES
SCALE 1:25

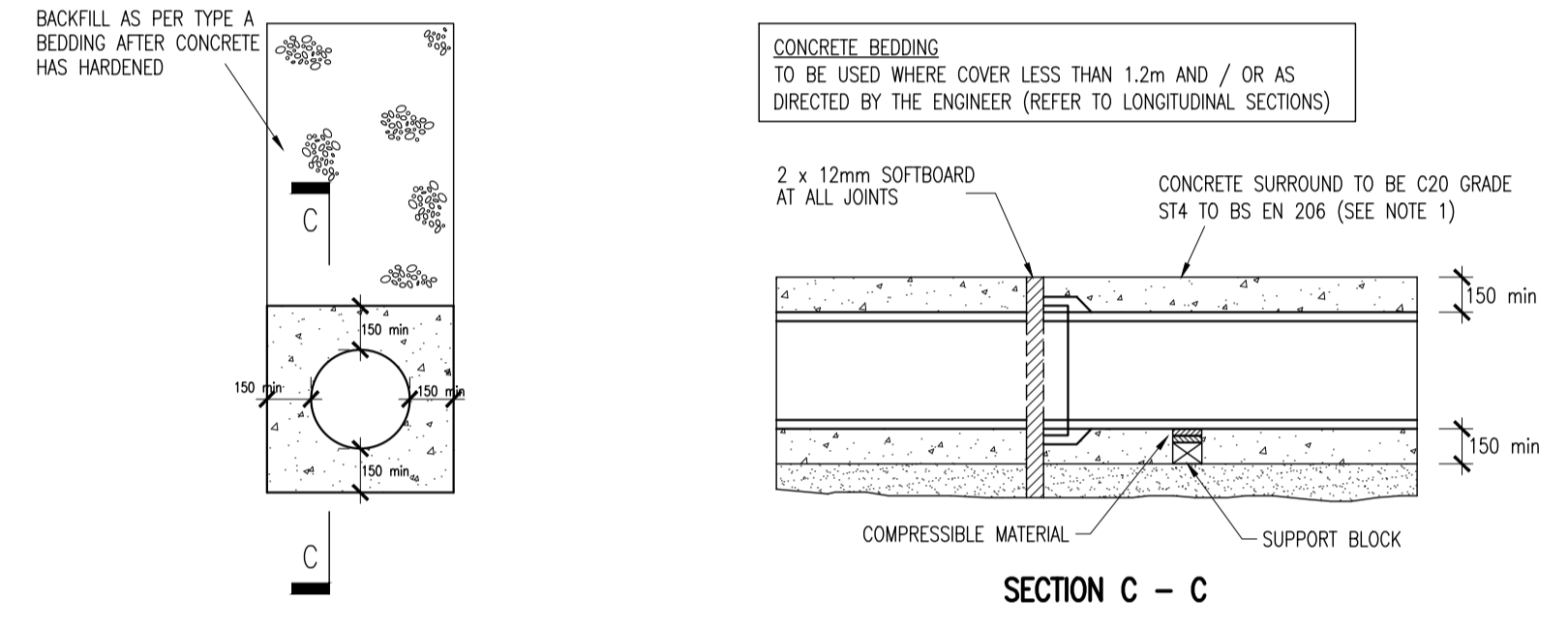

TYPE Z
CONCRETE BEDDING/SURROUND
(COVER 750mm - 1200mm)

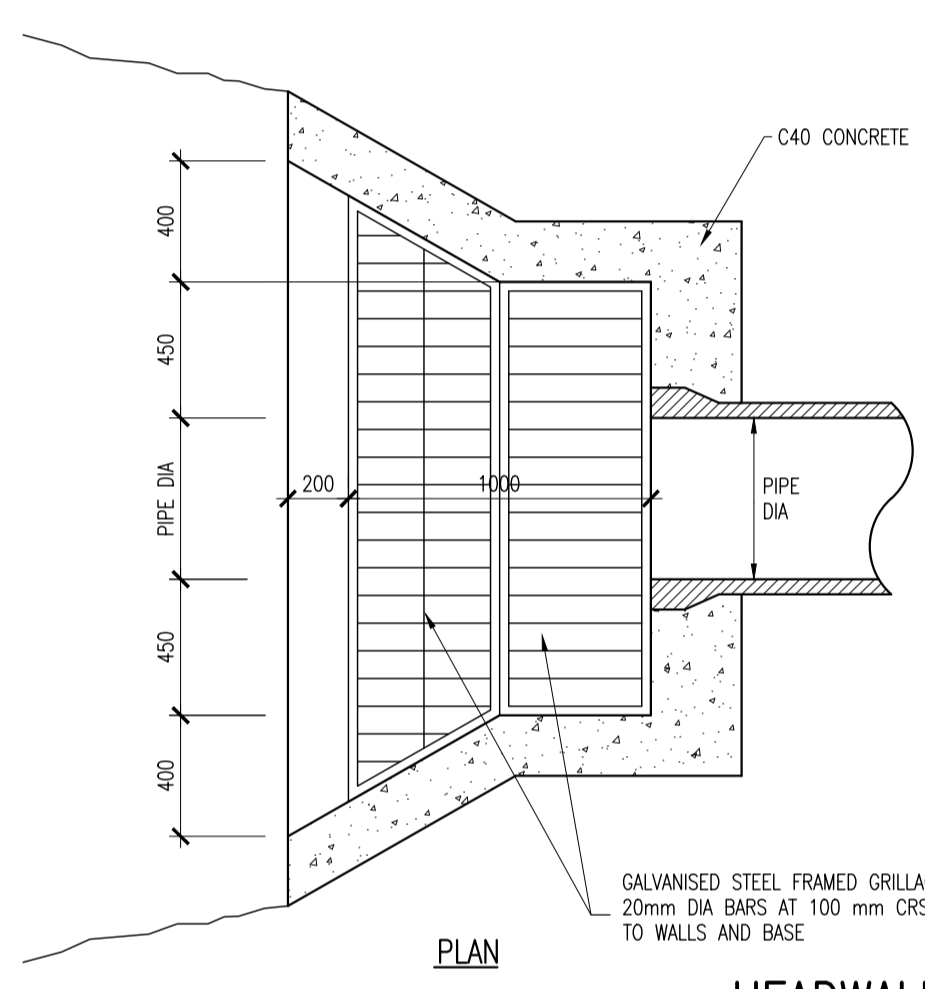

HEADWALL DETAILS
SCALE 1:25

DIAMETER OF LARGEST PIPE IN MANHOLE (mm)	CHAMBER SECTION DIAMETER (mm)
LESS THAN 375	1200 (1050 WHERE DEPTH TO SOFFIT IS 1.35m - 1.5m)
375 - 450	1350
500 - 700	1500
750 - 900	1800

TABLE 1

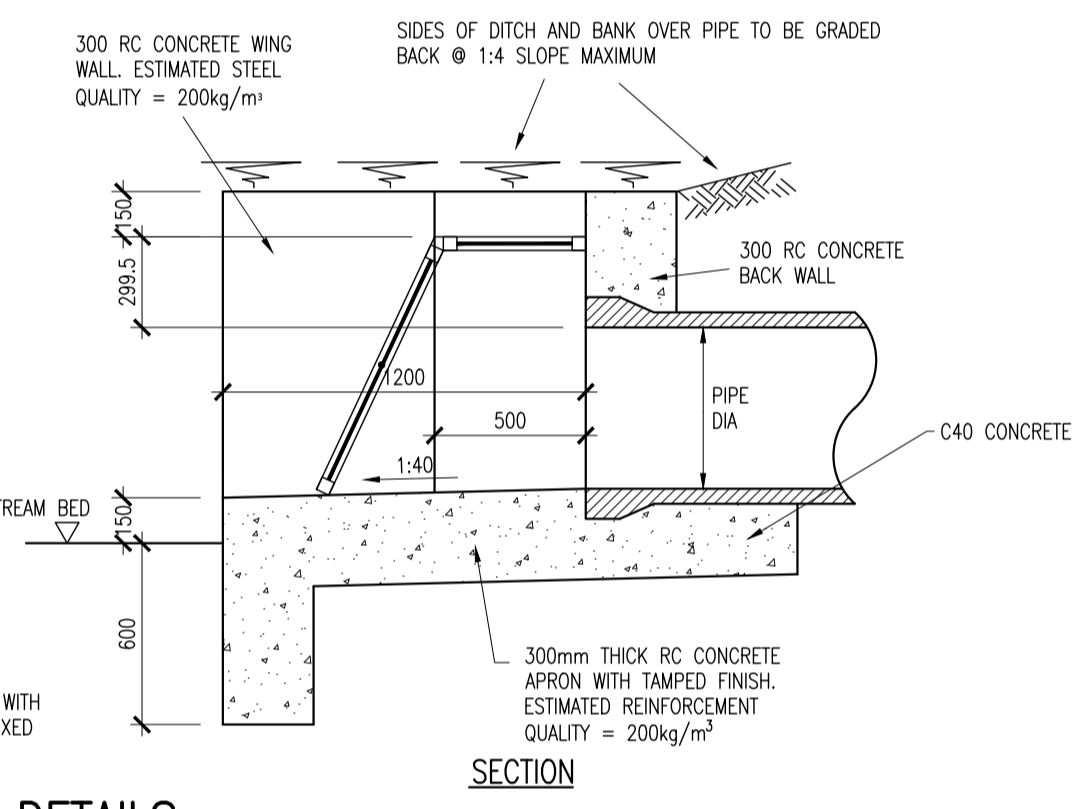

ROAD GULLY DETAILS SECTION
SCALE 1:25

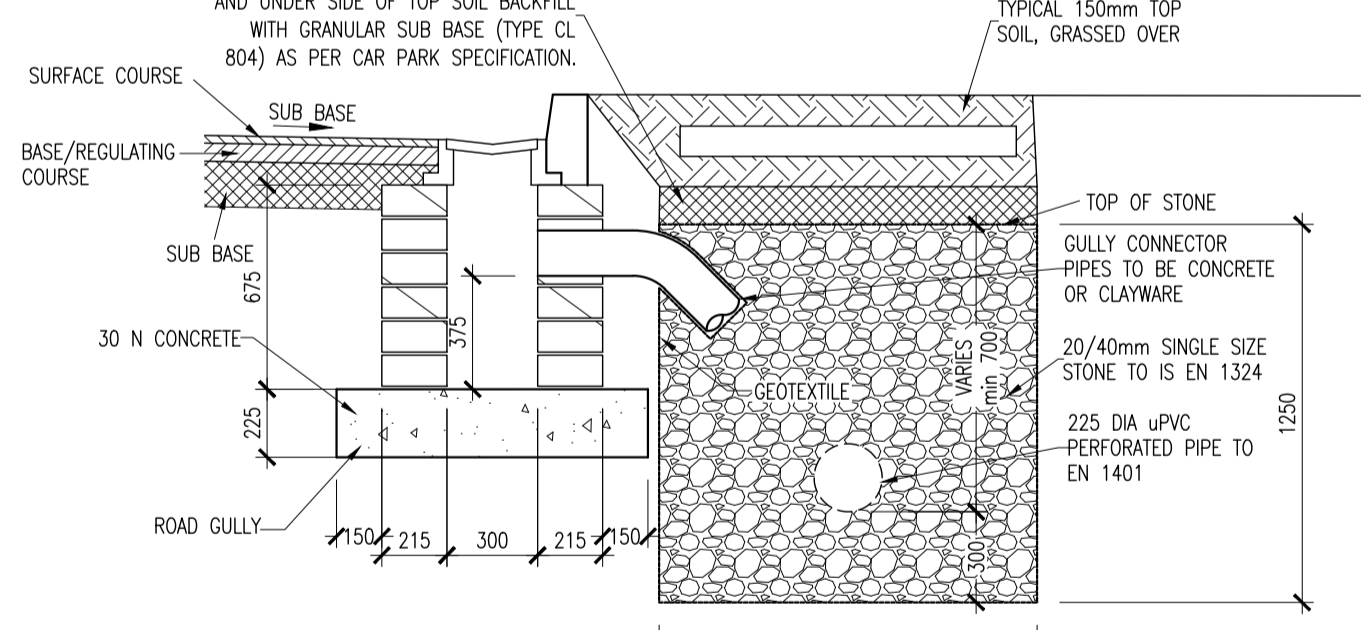

TYPICAL INFILTRATION TRENCH/ATTENUATION
(WITH KERB AND GULLY)
SCALE 1:25

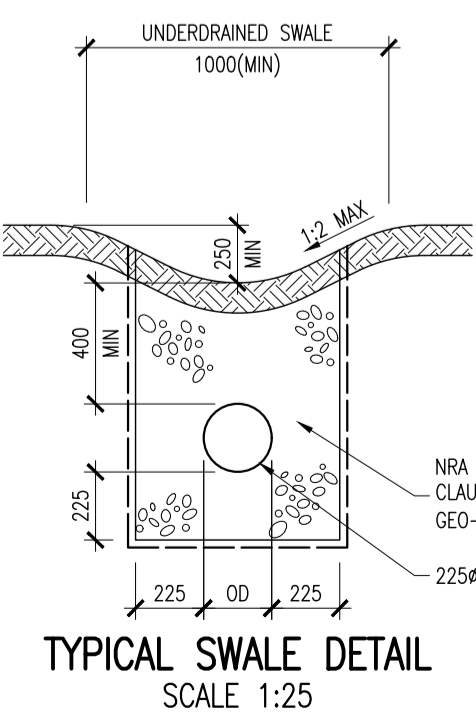

TYPICAL SWALE DETAIL
SCALE 1:25

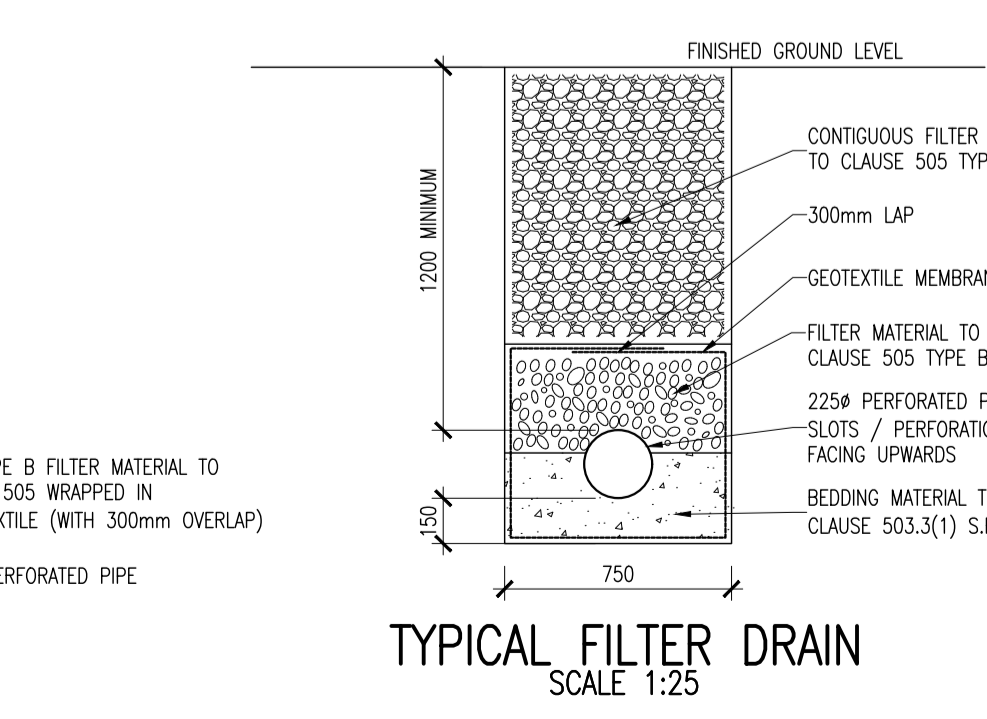

TYPICAL FILTER DRAIN
SCALE 1:25

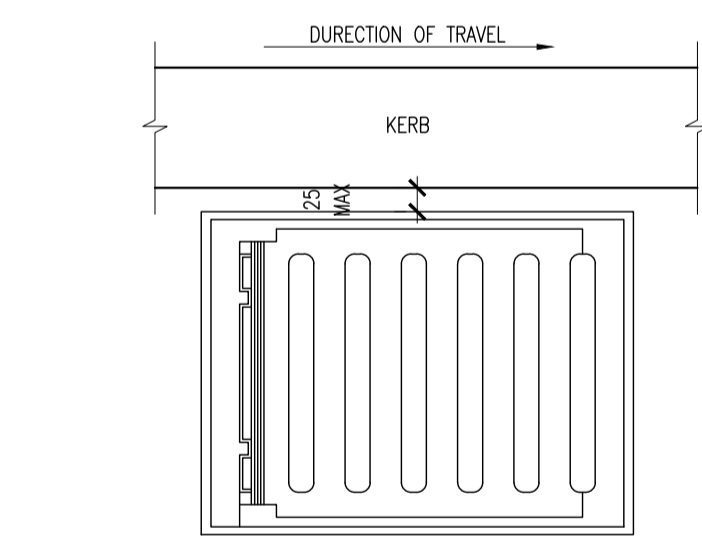

GULLY WITH CONNECTION ON OPPOSITE SIDE OF ROAD

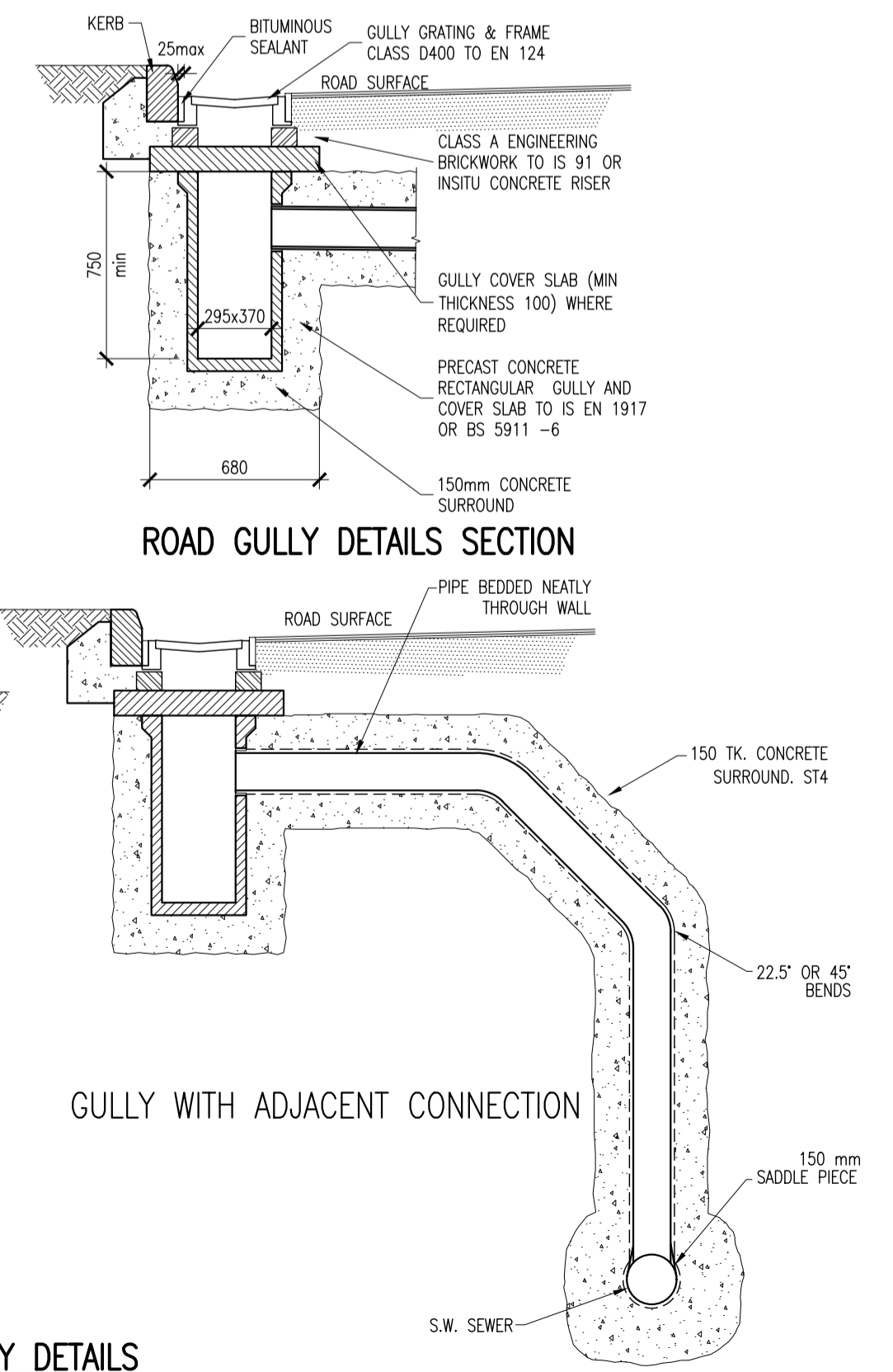

GULLY WITH ADJACENT CONNECTION

ROAD GULLY DETAILS
SCALE 1:25

© COPYRIGHT OF THIS DRAWING IS RESERVED BY DBFL CONSULTING ENGINEERS. NO PART SHALL BE REPRODUCED OR TRANSMITTED WITHOUT THEIR WRITTEN PERMISSION.

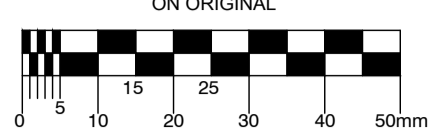

- NOTES:
- ALL WORKS TO BE CONSTRUCTED IN ACCORDANCE WITH NRA SPECIFICATION FOR ROAD WORKS U.N.O.
 - ALL REINFORCED CONCRETE ON THIS DRAWING SHALL BE U.N.O.: 35N20 COVER = 50mm MIN
 - SURFACE FINISHES FOR CONCRETE:
 - CLASS F1 FOR ALL CONCRETE 100mm OR MORE BELOW GROUND LEVEL
 - CLASS F3 FOR ALL EXPOSED CONCRETE ABOVE 100mm BELOW GROUND LEVEL
 - ALL EXPOSED CORNERS ON CONCRETE SHALL BE CHAMFERED WITH 25mm x 25mm CHAMFERS.
 - ALL STRUCTURAL CONCRETE (HEADWALLS, RC MANHOLES, PETROL INTERCEPTOR SLABS) TO RECEIVE MC DUR 1680 (OR SIMILAR APPROVED BAR MODIFIED EPOXY RESIN) TO ALL BURIED SURFACES, TO FINISH 100mm BELOW GROUND LEVEL.
 - ALL SEWERS SHALL BE PRESSURE TESTED PRIOR TO BACKFILLING.
 - RIGID PIPES SHALL MEAN CAST OR SPUN IRON, CONCRETE, ASBESTOS CEMENT OR CLAY.
 - CLASS D400 MANHOLE COVER FRAMES TO BE 150mm DEEP IN ROADS AND 100mm DEEP IN FOOTPATHS AND GREEN AREAS.
 - ALL AGGREGATES PROPOSED FOR USE ON THIS SCHEME SHALL MEET FULLY THE REQUIREMENTS OF THE NRA SPECIFICATION FOR ROAD WORKS AND IN ADDITION THE REQUIREMENTS STATED IN STANDARD RECOMMENDATION S.R. 21:2014 GUIDANCE ON THE USE OF U.S. EN 13242:2002 +A1:2007-AGGREGATES FOR UNBOUND AND HYDRAULICALLY BOUND MATERIALS FOR USE IN CIVIL ENGINEERING WORK AND ROAD CONSTRUCTION.
 - ALL SOIL SEWERS, MANHOLES, AND CONNECTIONS TO BE CONSTRUCTED IN ACCORDANCE WITH IRISH WATER CODE OF PRACTICE AND STANDARD DETAILS.
 - ALL SURFACE WATER SEWERS, MANHOLES, AND CONNECTIONS TO BE CONSTRUCTED IN ACCORDANCE WITH THE GREATER DUBLIN REGIONAL CODE OF PRACTICE FOR DRAINAGE WORKS.

PT	DATE	DESCRIPTION	BY	CHKD
17/12/19	PLANNING ISSUE		PJC	BCM
17/12/19	PLANNING ISSUE		PJC	BCM

STAGE 2 - PLANNING

DESIGNED	BCM	PREPARED	PJC
DATE	OCT 2019	CHECKED	DJR

DBFL Consulting Engineers email: info@dbfl.ie site: www.dbfl.ie

PROJECT
NEWTOWNMOYAGHY SHD

DRG. TITLE
TYPICAL SURFACE WATER DETAILS SHEET 3 OF 3

CLIENT
MCGARRELL REILLY

SCALE 1:25 @A1 FILE REF. 190009-DBFL-XX-XX-DR-C-3010
DRG. NO. 190009-DBFL-XX-XX-DR-C-3012 P1